

22' x 8' Skiff		
MAIN VIEWS		
SCALE 1/2" = 1'	DES/DWN WAL	DATE 10/8/17
Response Marine, Inc.		SHEET
Newburyport, MA, www.responsemarine.com		DWG NO. 202V2-1

REV.	DESCRIPTION

FRAME LOCATIONS						
#202v2, Chester	10/8/17					
INCHES-SIXTEENTHS Measured along Baseline						
	Distance From:					
	1A	F2	F3	F4	F5	F6
Item		(Fwd Side)	(Fwd Side)	(Fwd Side)	(Fwd Side)	(Fwd Side)
F1 (Aft Side)		36	72	108	143 13/16	179 13/16
F2 (Fwd Side)			36	72	107 13/16	143 13/16
F3 (Fwd Side)				36	71 13/16	107 13/16
F4 (Fwd Side)					35 13/16	71 13/16
F5 (Fwd Side)						36

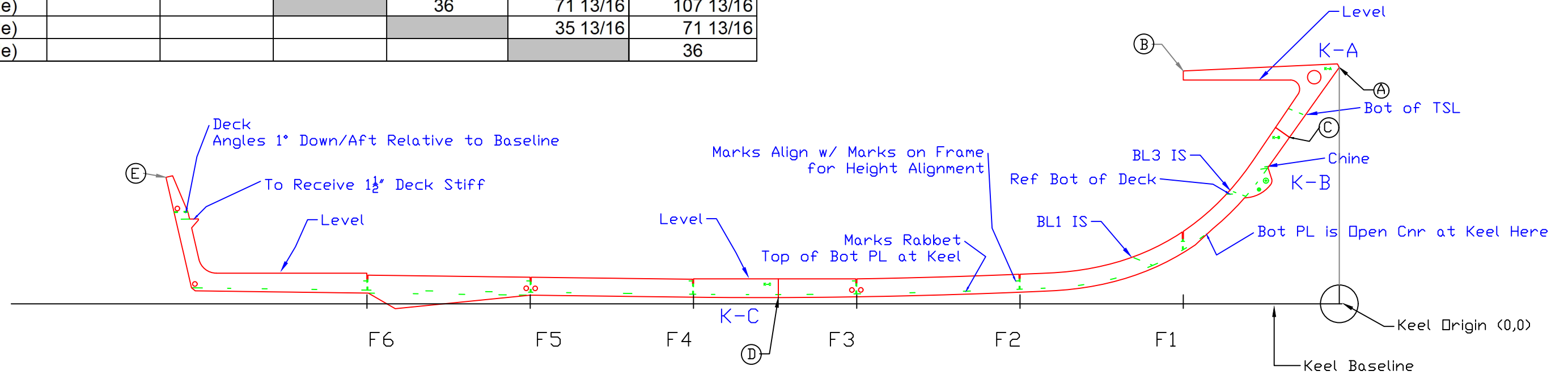

Response Marine, Inc.					
#202v2, Chester	10/8/17				
Keel Points					
	Inches- sixteenths			Feet	
	Horizontal	Vertical		Horizontal	Vertical
A to Origin					
B to Origin					
C to Origin					
D to Origin					
E to Origin					
A					
A to					
B to					
C to					
D to					

KEEL LAYOUT		
for: Response #202v2, Chester		
SCALE 1/2"=1'	DES/DWN WAL	DATE 10/8/17
Response Marine, Inc.		SHEET
Newburyport, MA, www.responsemarine.com		DWG NO. 202v2-2-1

REV.	DESCRIPTION

6

5
WTBHD

4

3
WTBHD

2

Frame 1

3/16" PL Girder w/ Flange → 3" x 1/4" FB (BL-1)

3/16" PL Girder w/ Flange → 3" x 1/4" FB (BL-2)

3/16" PL Girder w/ Flange → 3" x 1/4" FB (BL-3)

Chine, 3/8"

BG-3S

BL-3S

BG-2BS

BG-2AS

BL-2S

BG-1S

BL-1S

Girders Shown before Bending
Install w/ Flange Outboard

BOTTOM STIFFENERS

for: Response #202v2, Chester

SCALE 3/4"=1' DES/DWN WAL DATE 10/8/17

Response Marine, Inc. SHEET

Newburyport, MA, www.responsemarine.com DWG NO. 202v2-2-2

REV. DESCRIPTION

6 5 4 3 2 Frame 1
 WTBHD WTBHD

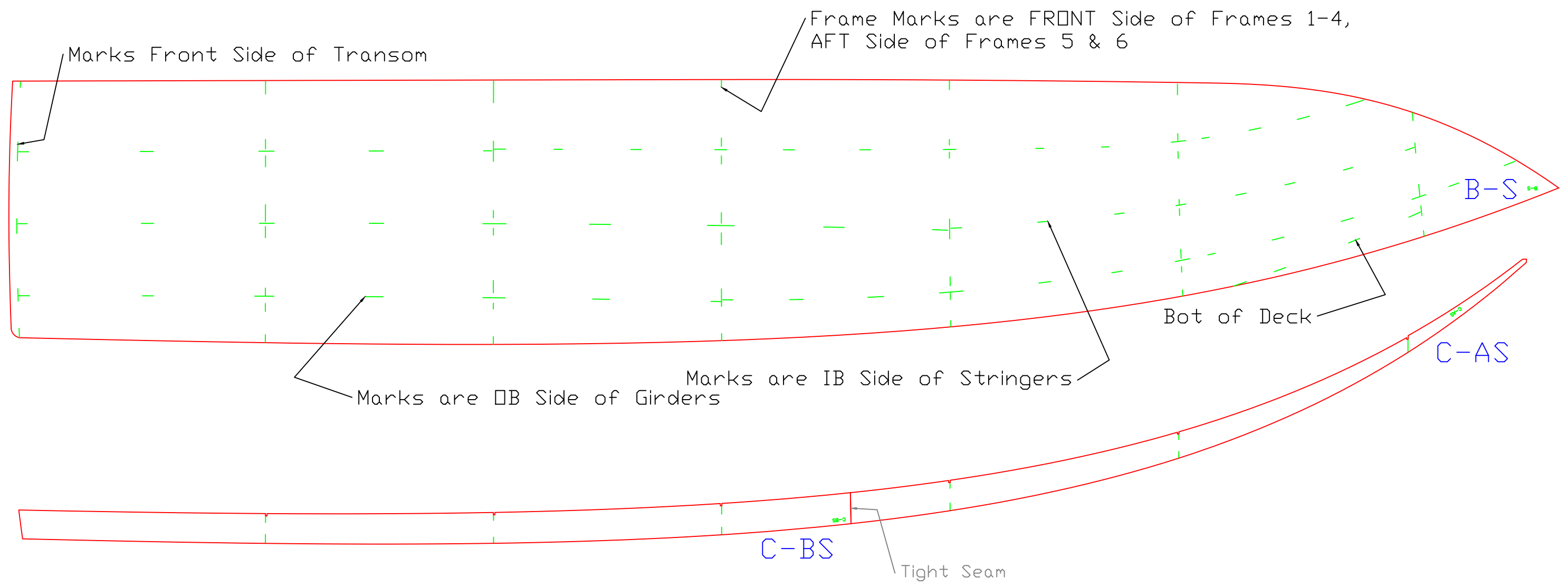

BOTTOM & CHINE PLATES		
for: Response #202v2, Chester		
SCALE 3/4"=1'	DES/DWN WAL	DATE 10/8/17
Response Marine, Inc. Newburyport, MA, www.responsemarine.com		SHEET DWG NO. 202v2-2-3

REV.	DESCRIPTION

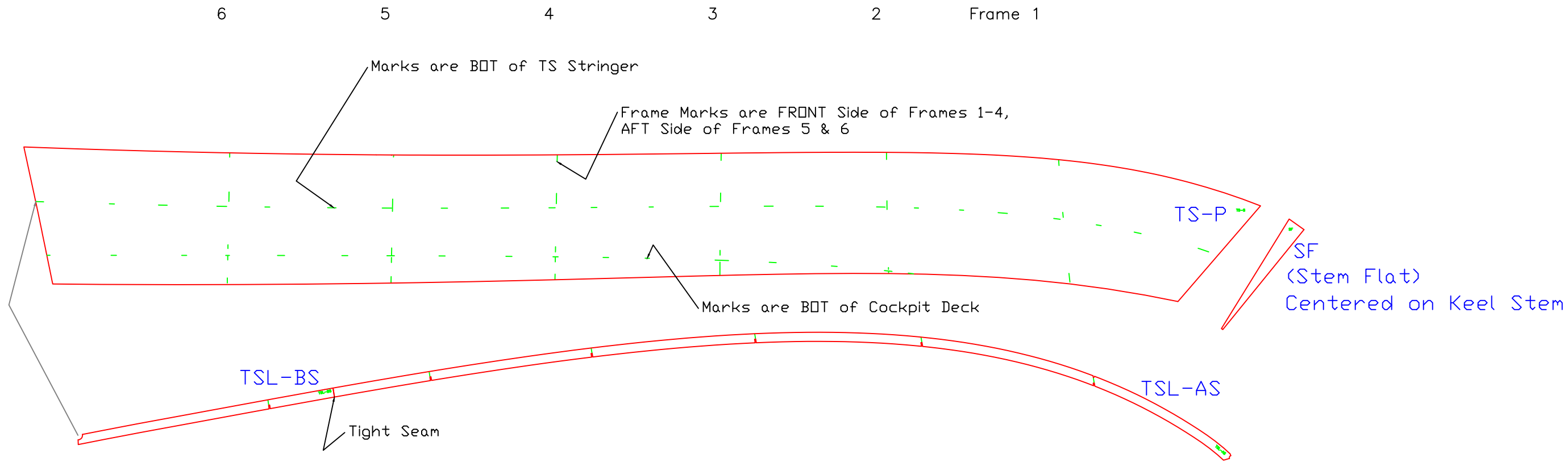

TOPSIDES PL & STRINGER		
for: Response #202v2, Chester		
SCALE 1/2"=1'	DES/DWN WAL	DATE 10/8/17
Response Marine, Inc. Newburyport, MA, www.responsemarine.com		SHEET DWG NO. 202v2-2-4

REV.	DESCRIPTION

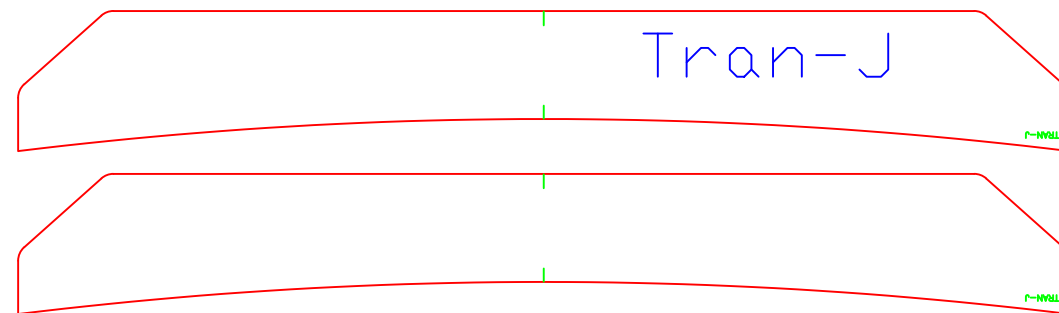
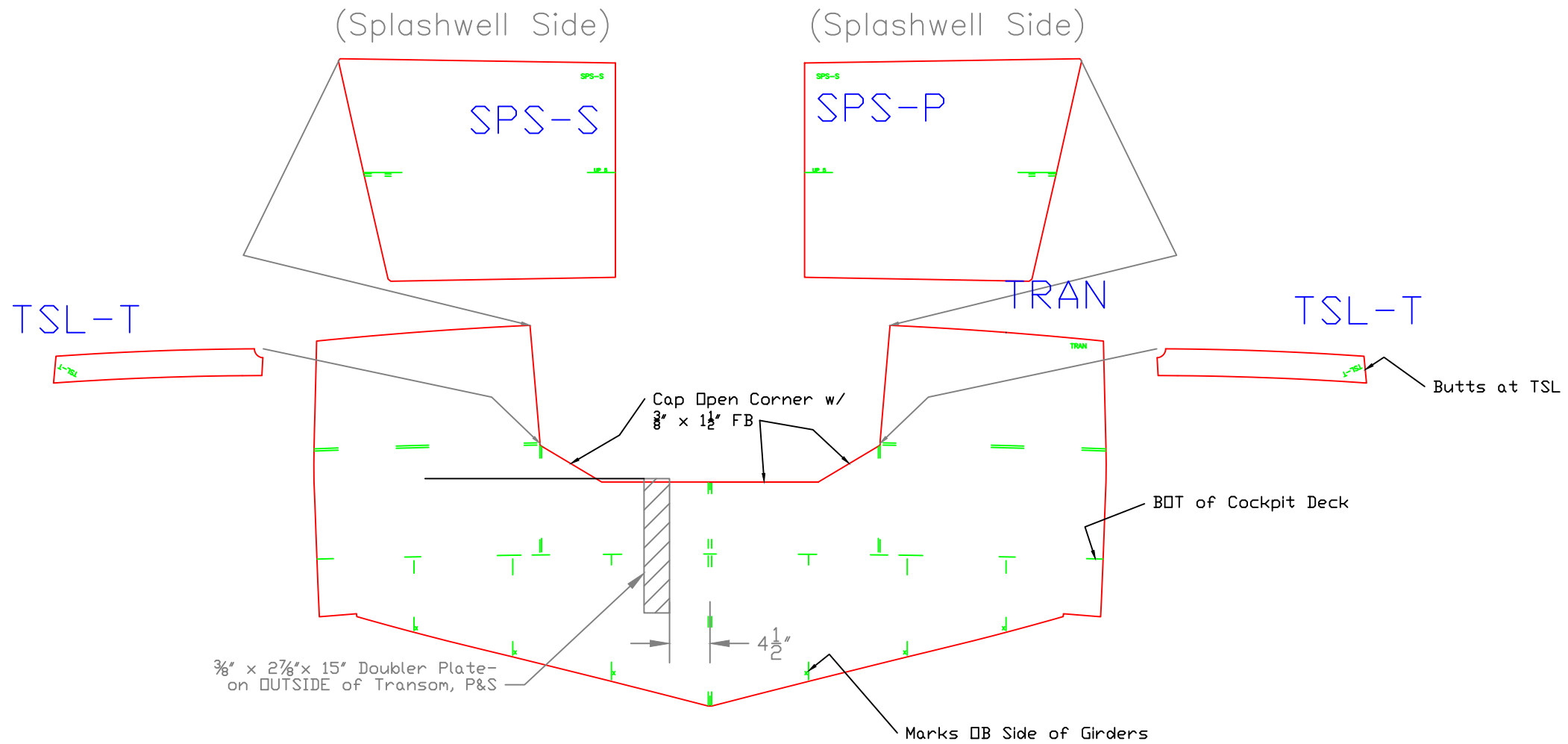

Transom Jigs
Fit Square off Transom

TRANSOM		
for: Response #202v2, Chester		
SCALE 3/4"=1'	DES/DWN WAL	DATE 10/8/17
Response Marine, Inc.		SHEET
Newburyport, MA, www.responsemarine.com		DWG NO. 202v2-2-5

REV.	DESCRIPTION

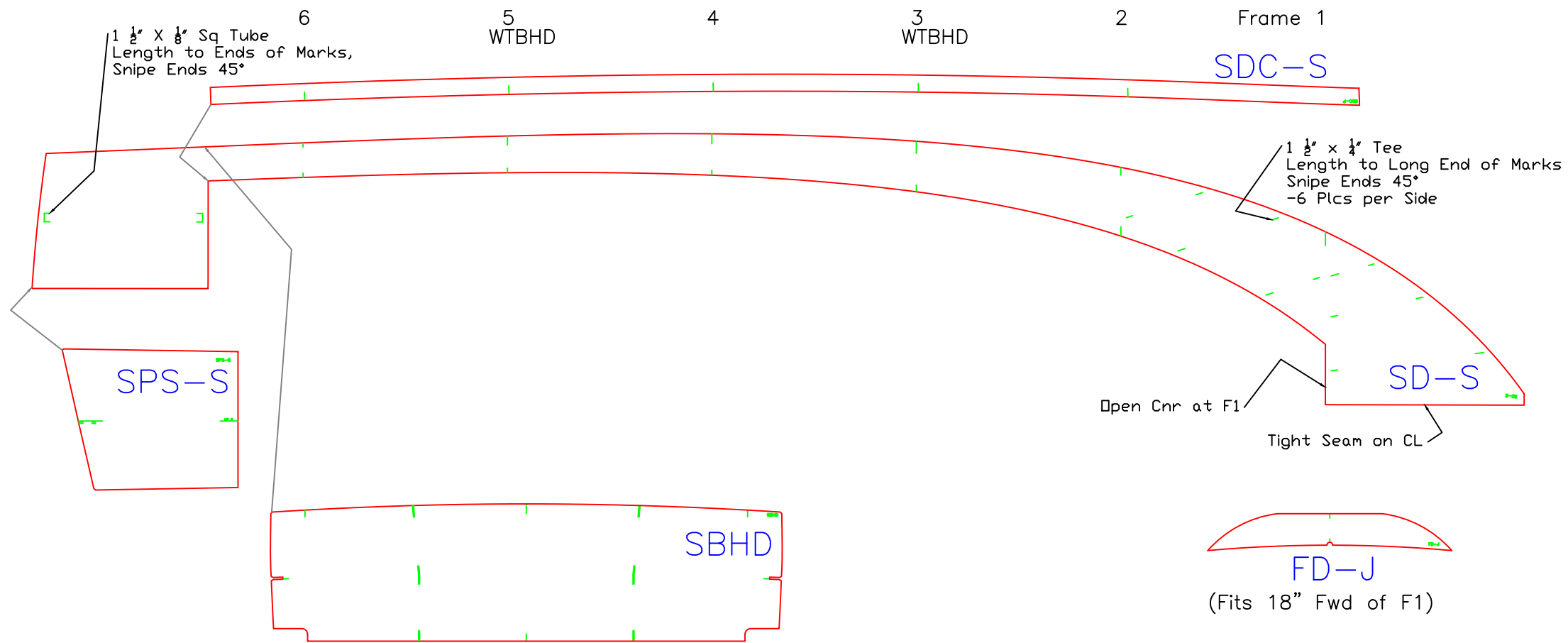

SIDE & FORE DECKS		
for: Response #202v2, Chester		
SCALE 1/2"=1'	DES/DWN WAL	DATE 10/8/17
Response Marine, Inc. Newburyport, MA, www.responsemarine.com		SHEET DWG NO. 202v2-2-6

REV.	DESCRIPTION

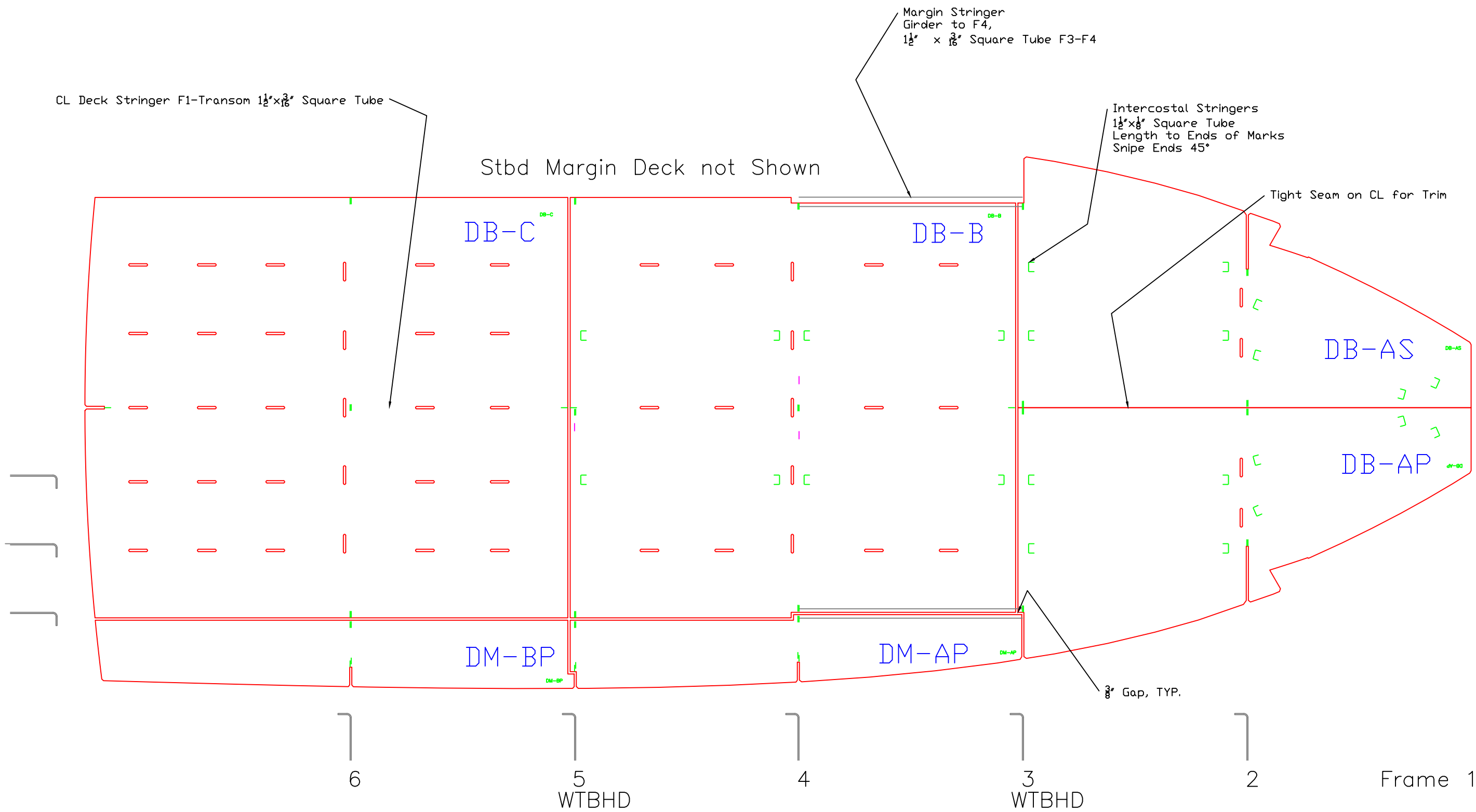

Deck Viewed from Below

COCKPIT DECK		
for: Response #202v2, Chester		
SCALE 3/4"=1'	DES/DWN WAL	DATE 10/8/17
Response Marine, Inc. Newburyport, MA, www.responsemarine.com		SHEET DWG NO. 202v2-2-7

REV.	DESCRIPTION

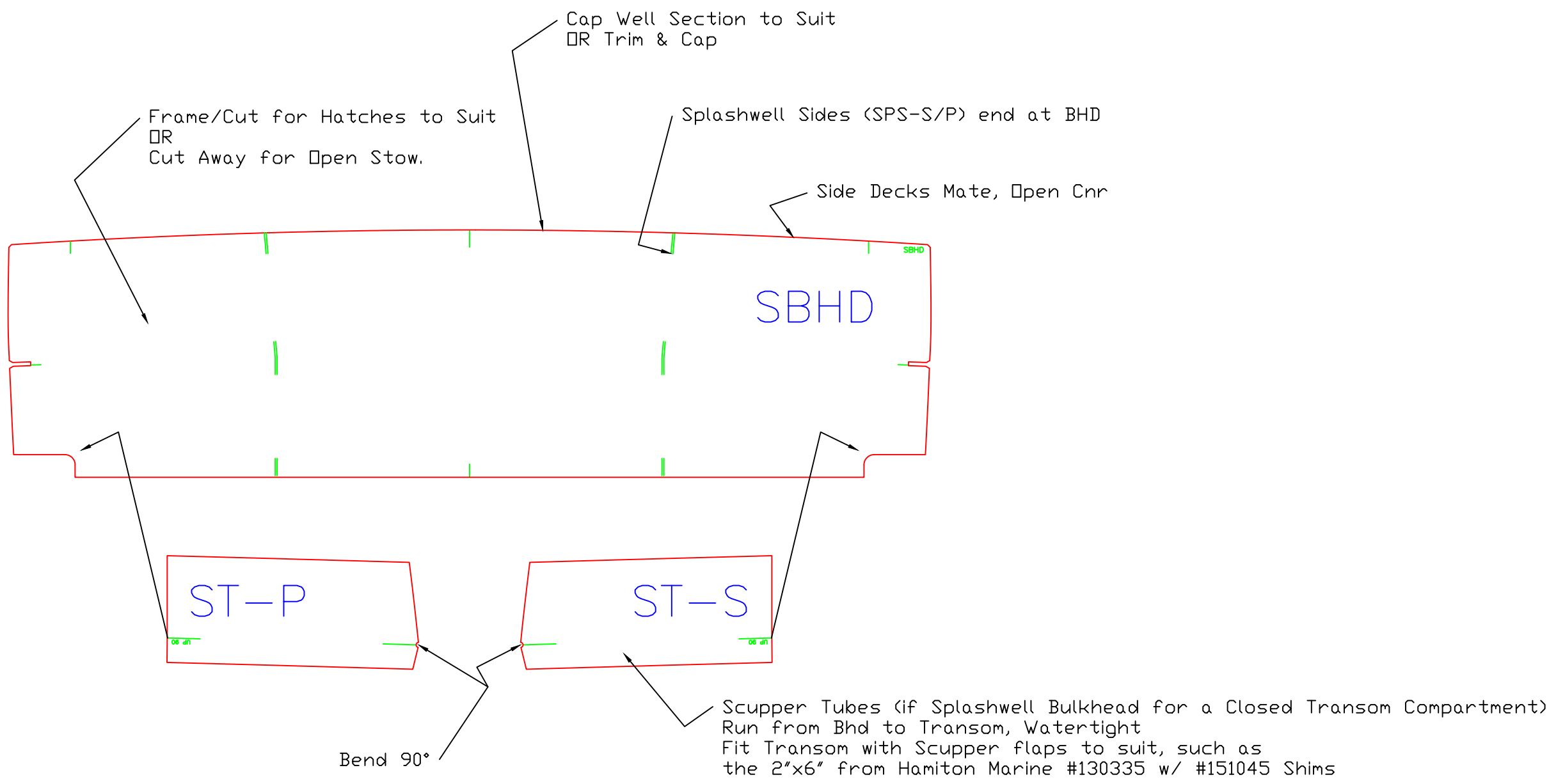

TRANSOM BULKHEAD		
for: Response #202v2, Chester		
SCALE 1"=1'	DES/DWN WAL	DATE 10/8/17
Response Marine, Inc. Newburyport, MA, www.responsemarine.com		SHEET DWG NO. 202v2-2-8

REV.	DESCRIPTION

Stock: .190" 5052

- Bends are tight radius, appropriate for 5052
- Hatches & Stiffeners to Suit

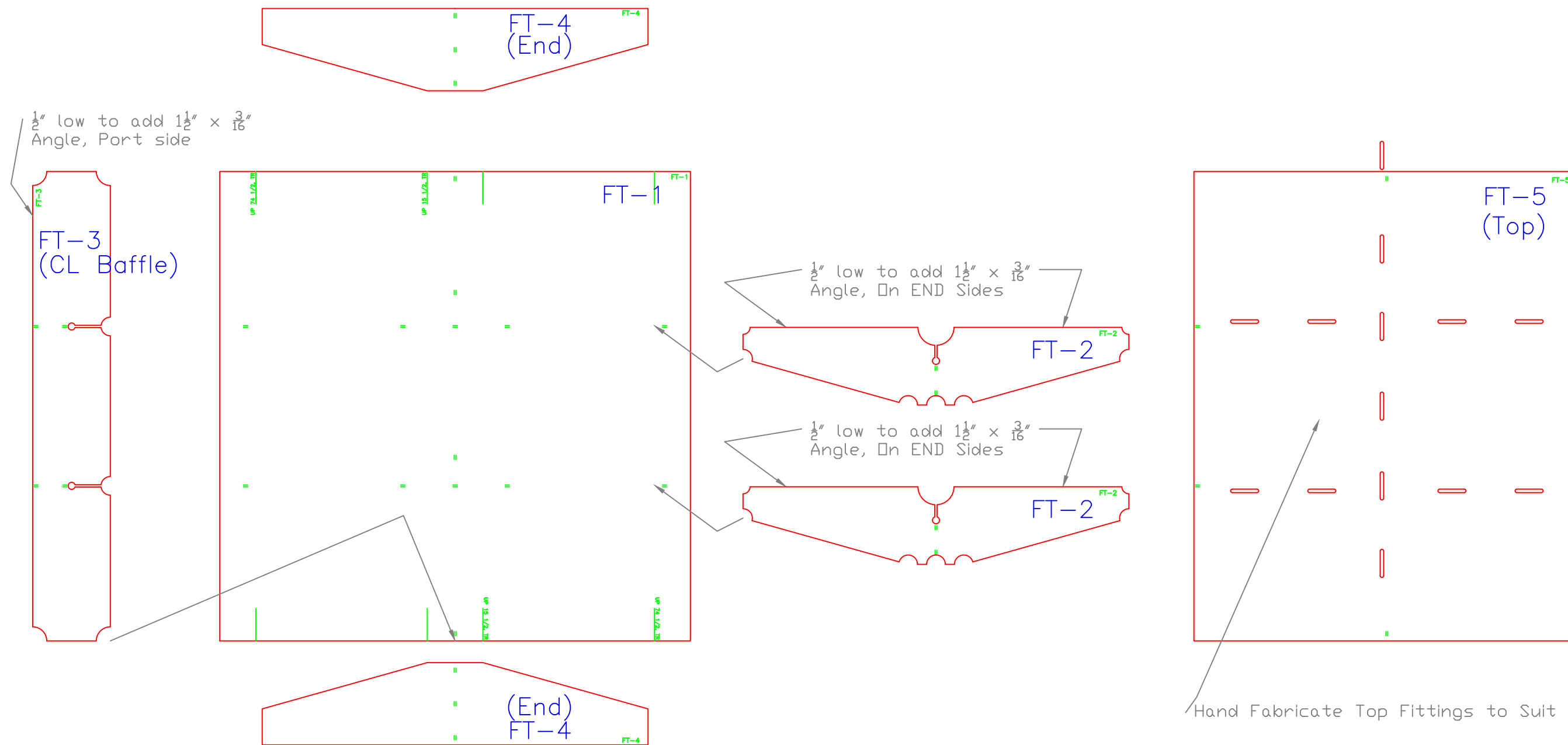

Fuel Tank, 60gal Gross		
for: Response #202v2, Chester		
SCALE 1"=1'	DES/DWN WAL	DATE 10/8/17
Response Marine, Inc. Newburyport, MA, www.responsemarine.com		SHEET DWG NO. 202v2-3-1

REV.	DESCRIPTION

Stock: .190" 5052

- Bends are tight radius, appropriate for 5052
- Hatches & Stiffeners to Suit

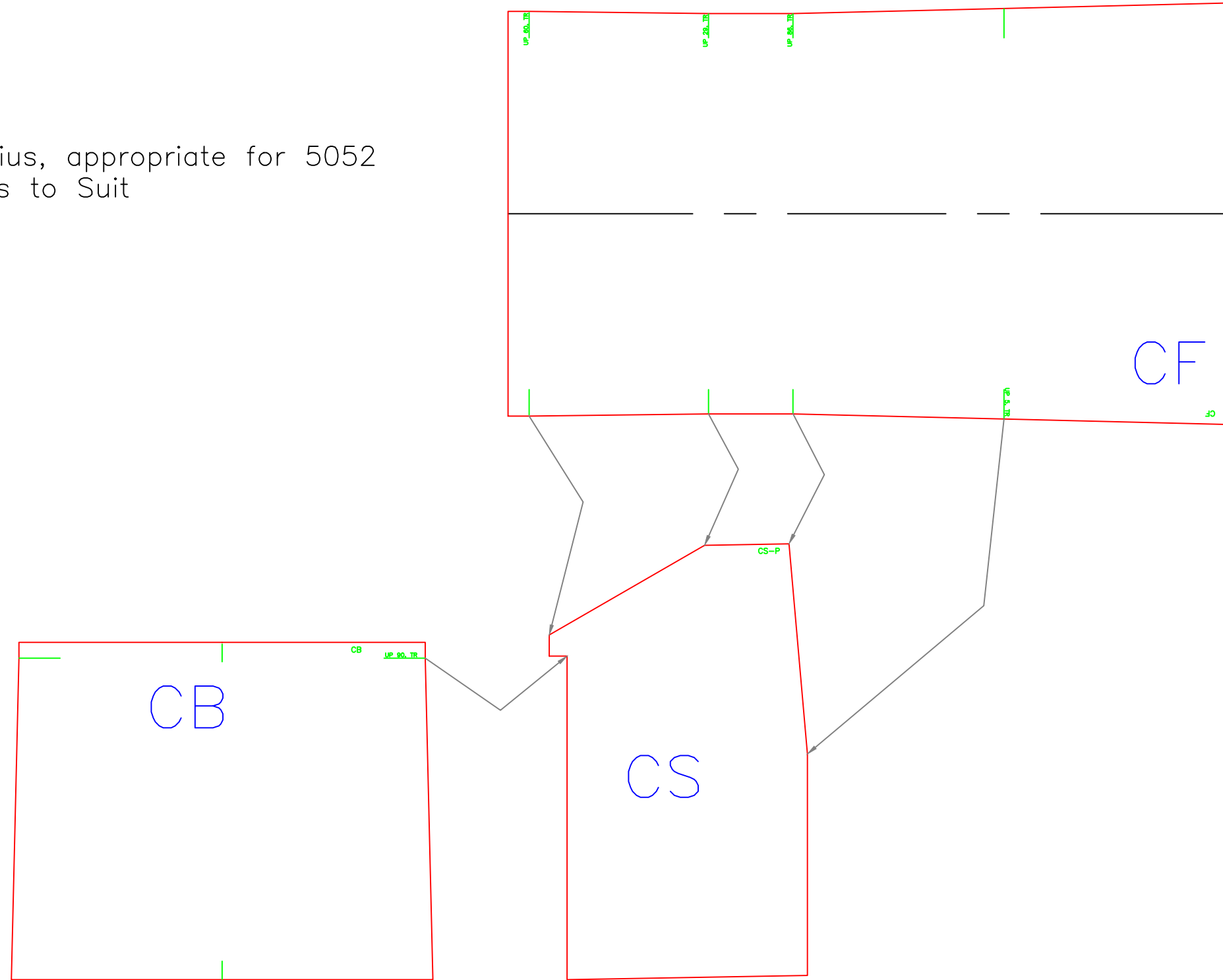

Center Console		
for: Response #202v2, Chester		
SCALE 1"=1'	DES/DWN WAL	DATE 10/8/17
REV. DESCRIPTION		SHEET
Response Marine, Inc. Newburyport, MA, www.responsemarine.com		DWG NO. 202v2-4-1

STANDARD FLANGE BENDING: $\frac{3}{16}$ " 5086/83 H116 Stock

- 1) Confirm results for dimensions and cracking with test strips before bending frames.
- 2) Expected Die Radius is $\frac{1}{2}$ "
- 3) Flanges are designed for outside major flange length of $1\frac{1}{2}$ " less than flat stock length as shown.
- 4) Expected Back Gauge setting is 1.74", but confirm and adjust, based on test strip.

Parts to be flanged per this same set-up are listed at left.

1	BG-1P	Bottom Girder #1, F5-Tran, Port
1	BG-1S	Bottom Girder #1, F5-Tran, Stbd
1	BG-2AP	Bottom Girder #2, fwd, F3-F4, Port
1	BG-2AS	Bottom Girder #2, fwd, F3-F4, Stbd
1	BG-2BP	Bottom Girder #2, aft, F4-Tran, Port
1	BG-2BS	Bottom Girder #2, aft, F4-Tran, Stbd
1	BG-3P	Bottom Girder #3, F4-Tran, Port
1	BG-3S	Bottom Girder #3, F4-Tran, Stbd
1	F3	Frame 3 (bottom)
1	F4	Frame 4 (bottom)
1	F4-P	Frame 4- Upper, Port
1	F4-S	Frame 4 - Upper, Stbd
1	F5	Frame 5 (bottom)
1	F5-P	Frame 5- Upper, Port
1	F5-S	Frame 5- Upper, Stbd
1	F6	Frame 6 (bottom)
1	F6-P	Frame 6- Upper, Port
1	F6-S	Frame 6- Upper, Stbd
18	Total	
18	Total	

Bends are 90°, EXCEPT these 4 Frame Bottoms which are 91°

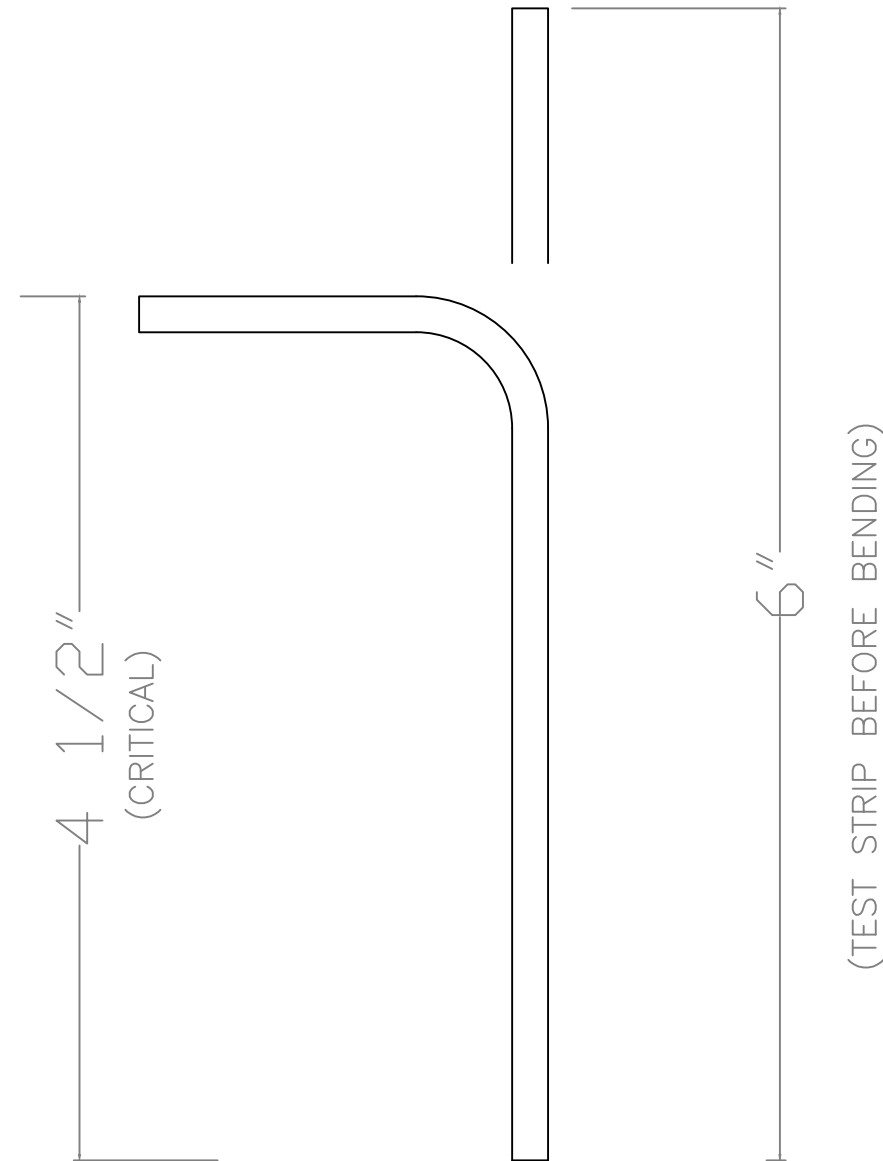

Flange "B1" Bending		
for: Response #202v2, Chester		
SCALE 1"=1'	DES/DWN WAL	DATE 10/8/17
Response Marine, Inc. Newburyport, MA, www.responsemarine.com		SHEET DWG NO. 202v2-B1

REV.	DESCRIPTION

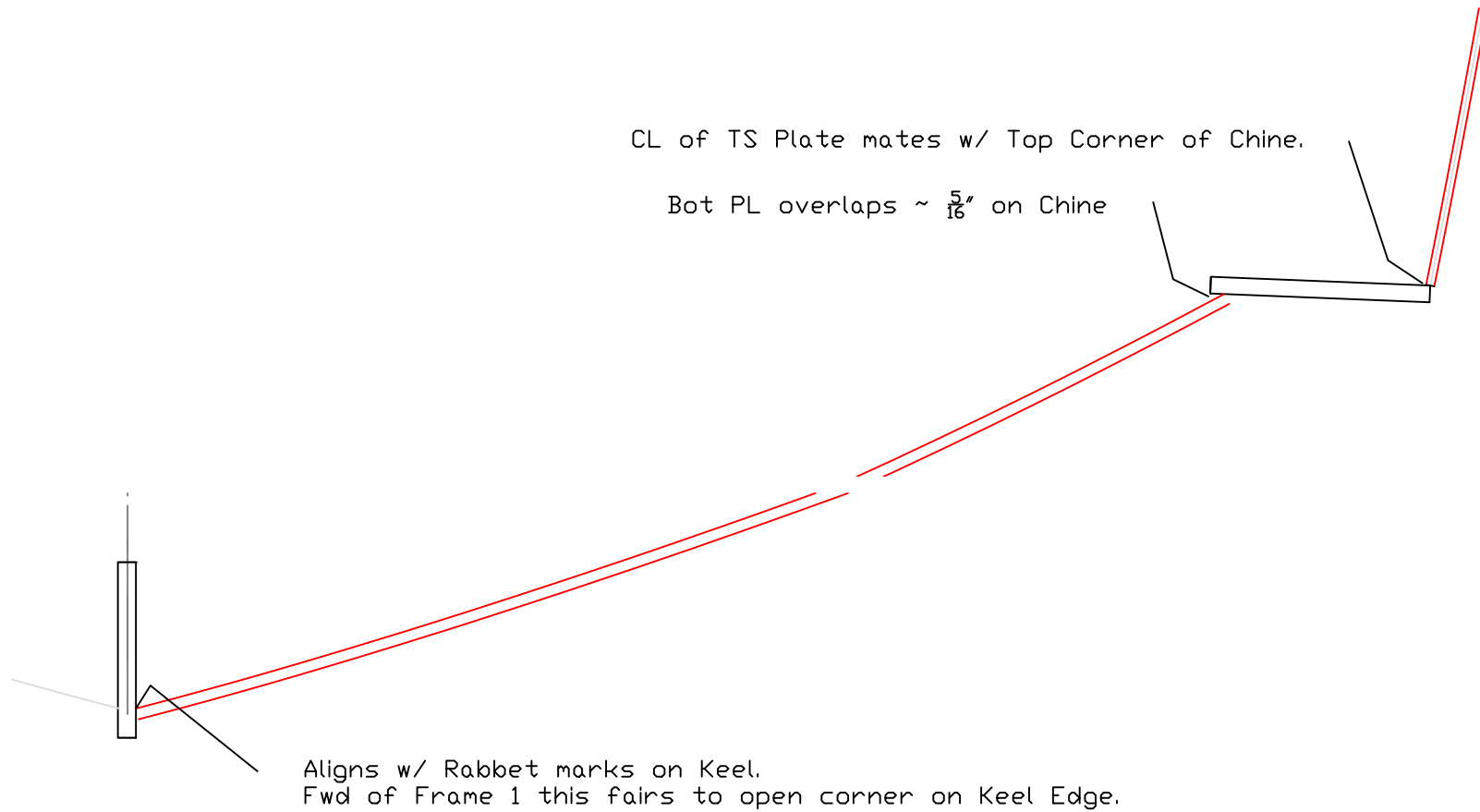

CL of TS Plate mates w/ Top Corner of Chine.

Bot PL overlaps ~ $\frac{5}{16}$ " on Chine

Aligns w/ Rabbet marks on Keel.
Fwd of Frame 1 this fairs to open corner on Keel Edge.

TYPICAL BOTTOM JOINTS		
for: Response #202v2, Chester		
SCALE 3" = 1'	DES/DWN WAL	DATE 10/8/17
Response Marine, Inc. Newburyport, MA, www.responsemarine.com		SHEET DWG NO. 202v2-C1

REV.	DESCRIPTION

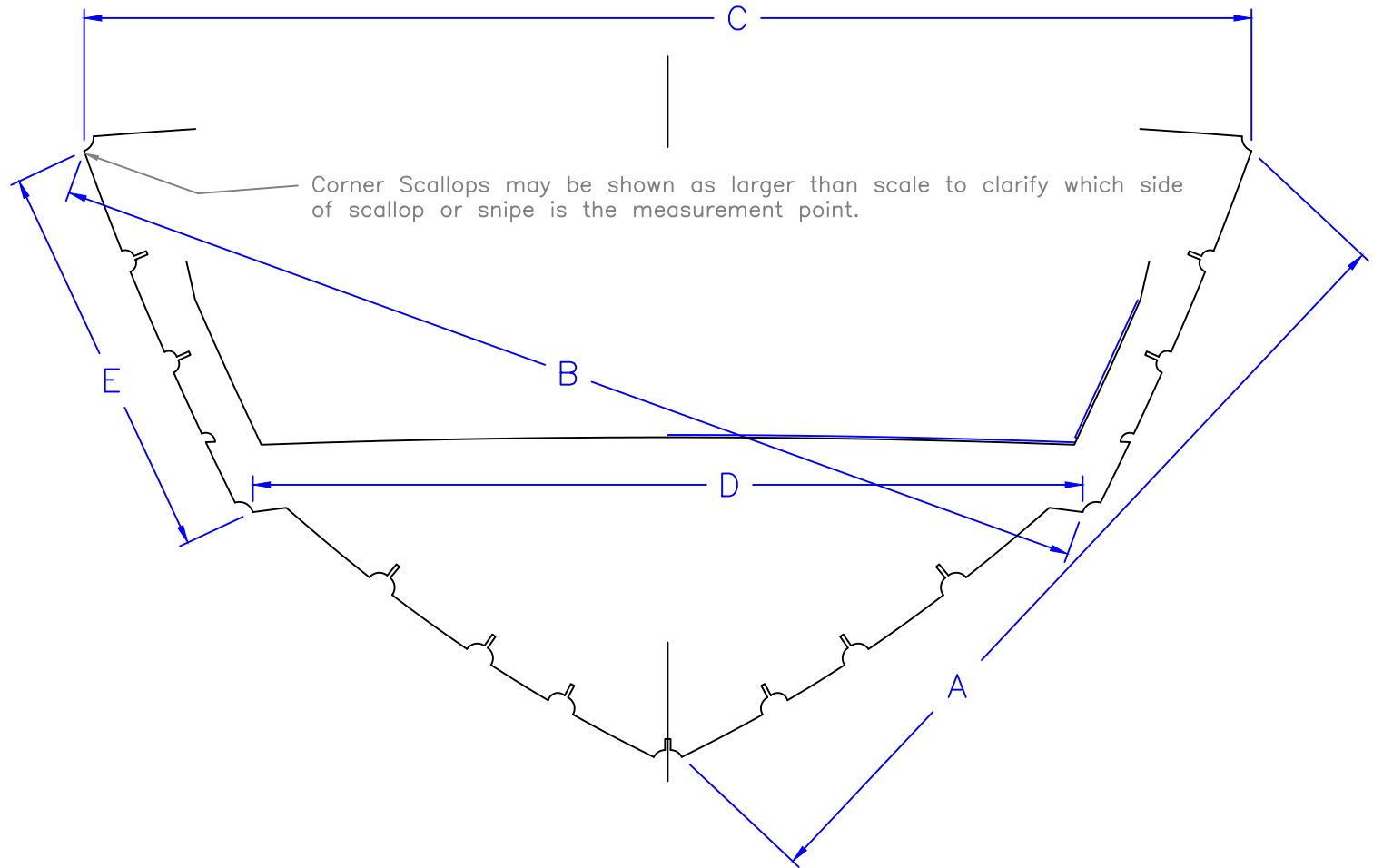

Response Marine, Inc.
 #202v2, Chester 10/8/17
 FRAME DIMENSIONS

Inches- sixteenths					
	A	B	C	D	E
F1					
F2					
F3					
F4					
F5					
F6					

FRAME DIMENSIONS		
for: Response #202v2, Chester		
SCALE NONE	DES/DWN WAL	DATE 10/8/17
Response Marine, Inc.		SHEET
Newburyport, MA, www.responsemarine.com		DWG NO. 202v2-FR

REV.	DESCRIPTION

Cutout for
 Bomar # 41020, Alum Lift Out
 or Bomar # 81020, Plastic, Hinged
 or enlarge length slightly for
 Bomar #71020, Plastic, hinged 180° open

Install w/ Marks Fwd

Stiff w/ 1½"x1" Sq. Tube,
 2 Verticals & 1 Cross,
 or to Suit
 Snipe Top & Bottom 45°

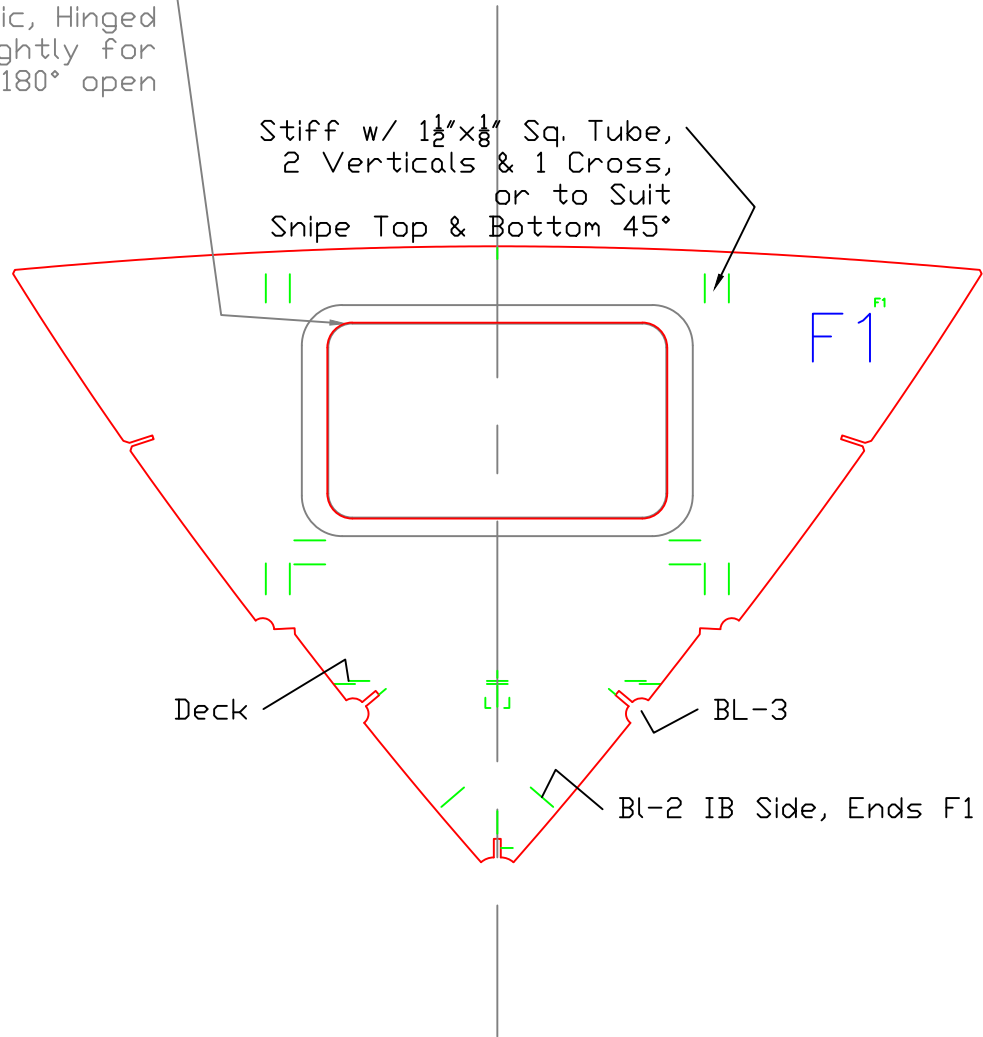

FRAME 1		
for: Response #202v2, Chester		
SCALE 1" = 1'	DES/DWN WAL	DATE 10/8/17
Response Marine, Inc.		SHEET
Newburyport, MA, www.responsemarine.com		DWG NO. 202v2-F1

REV.	DESCRIPTION

**Install w/ Marks & Flanges AFT
Flanges Shown before Bending**

F4-P

F4-S

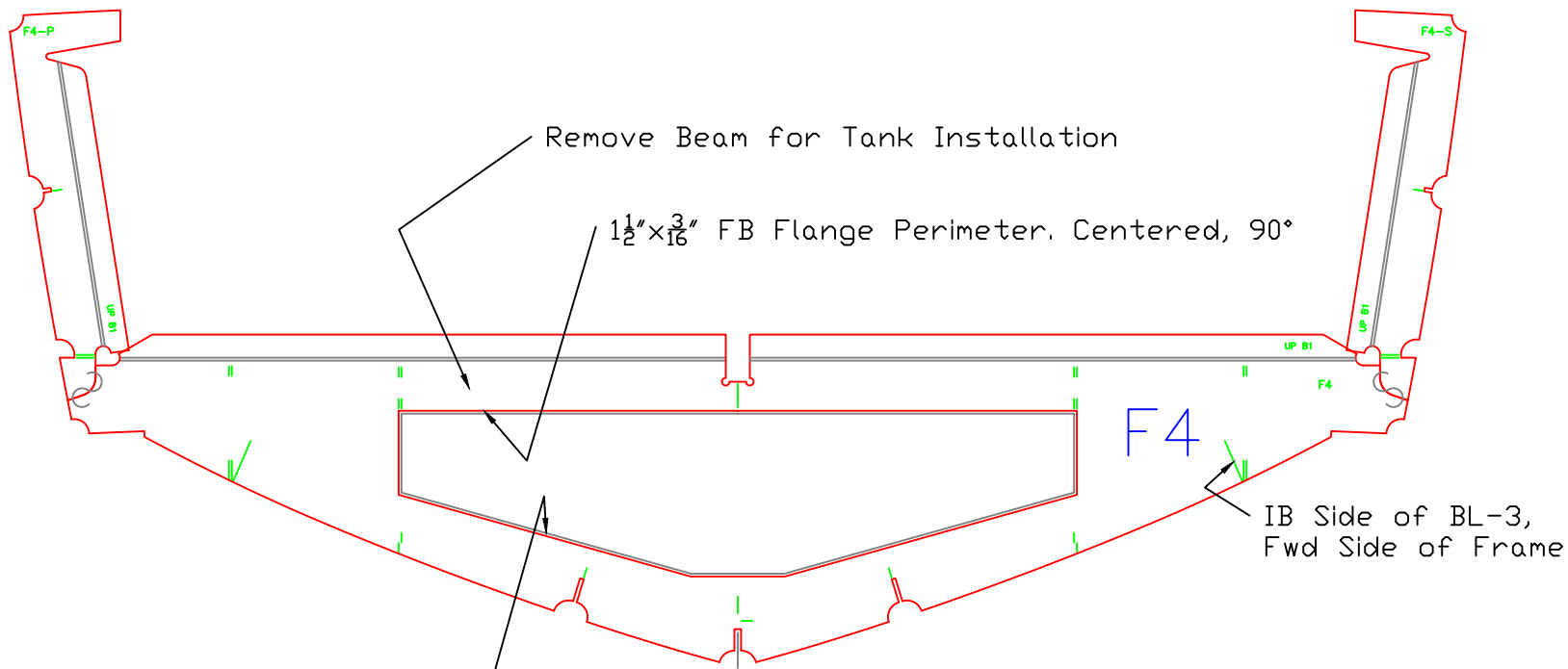

Remove Beam for Tank Installation

1 1/2" x 3/16" FB Flange Perimeter, Centered, 90°

F4

IB Side of BL-3,
Fwd Side of Frame

Top of Flange is 1/4" Beyond Tank Skin

FRAME 4		
for: Response #202v2, Chester		
SCALE 1" = 1'	DES/DWN WAL	DATE 10/8/17
Response Marine, Inc.		SHEET
Newburyport, MA, www.responsemarine.com		DWG NO. 202v2-F4

REV.	DESCRIPTION